

## FCS-MCB-RG142-3

SMA Male Crimp

## Features:

- \* Low VSWR

### Applications:

- \* Wireless
- \* Radar
- \* Instruments
- \* Electronics

## Electrical

Frequency:	DC~6GHz
VSWR:	1.15 max.@DC~3GHz
Impedance:	50Ω

## Mechanical

RF Connector:	SMA male
Mating Cable:	RG223, RG58, LMR195, RG142
Outer Conductor:	Gold Plated Brass
Inner Conductor:	Gold Plated Brass

## Outline Drawings

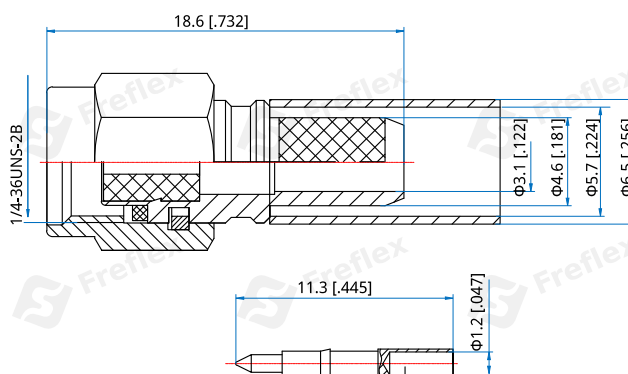

Unit: mm [in]

Tolerance:  $\pm 0.2\text{mm}$  [ $\pm 0.008\text{in}$ ]

## How To Order

**FCS-MCB-RG142-3**

Customization is available upon request.