

## FAPA

### SMP to SSMA

Features:  
\* Low VSWR

Applications:  
\* Wireless  
\* Transmitter  
\* Laboratory Test  
\* Radar

#### Electrical

Frequency: DC~18GHz  
VSWR: 1.25 max.  
Impedance: 50Ω

#### Mechanical

RF Connectors: SMP  
SSMA  
Outer Conductor: Gold plated brass  
Dielectric: PTFE  
Inner Conductor: Gold plated beryllium copper

#### Environmental

Temperature: -50~+85°C

#### How To Order

**FAPAL-FF** - SMP (f) to SSMA (f), Flange mount, Outline A

Customization is available upon request.

#### Outline Drawings

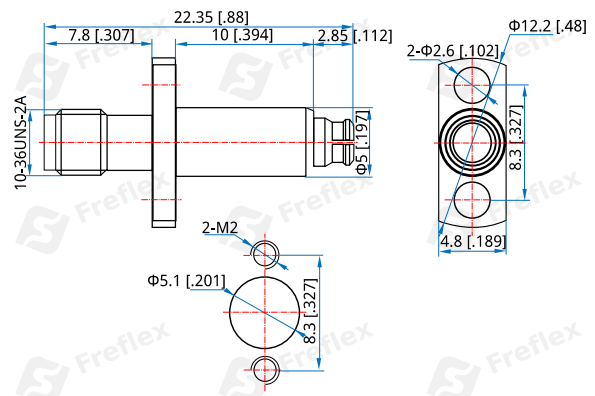

Outline A

Unit: mm [in]

Tolerance: ±0.2mm [±0.008in]