

FCC5050B

High Power, High Isolation

Features:

- * High Power
- * High Isolation
- * Low Insertion Loss
- * Low VSWR

Applications:

- * Wireless
- * Radar
- * Laboratory Test

Description

FCC5050B series Coaxial Circulators cover frequency range 0.26~0.33GHz. High power, high isolation and low insertion loss make it ideal for a lot of applications like amplifiers, transceivers, etc.

Specifications

Frequency (MHz)	Bandwidth (MHz)	IL (dB Max.)	Isolation (dB Min.)	VSWR (Max.)	Average Power (W)	Connector	Temperature (°C)
260~330	70	0.6	15	1.45	300	N	0~+60

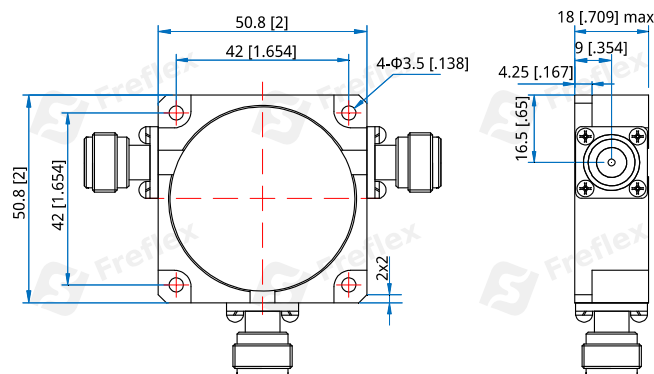
Outline Drawings

Unit: mm [inch]

Tolerance: ±0.2mm [±0.008in]

Mechanical

Size^{*1}: 50.8*50.8*18mm

2*2*0.709in

Mounting: 4-Φ3.5mm through-hole

[1] Exclude connectors

Connector Naming Rules:

N - N Female

Direction Naming Rules:

1 - Clockwise

2 - Anticlockwise

How To Order

FCC5050B-V-W-X-Y-Z

V: Start frequency in MHz

W: Stop frequency in MHz

X: Average power in W

Y: Connector type

Z: Direction type

Examples:

To order a FCC5050B series Circulator, 260~330MHz, 300W, N female, Clockwise, specify FCC5050B-260-330-K3-N-1.

Customization is available upon request.