

FCCC-4000-8000-04-S

4~8GHz, 4K, SMA Female

Features:

- * High Isolation
- * Low Insertion Loss

Applications:

- * Wireless
- * Radar
- * Laboratory Test
- * Quantum Computing

Electrical

Frequency:	4~8GHz
Insertion Loss:	0.2dB
VSWR:	1.3
Isolation:	20dB
Impedance:	50Ω

Mechanical

Size ^{*1} :	24.2*25.5*13.7mm 0.953*1.004*0.539in
RF Connectors:	SMA female
Cavity:	Gold plated OFC
Shielding Layer:	Nickel plated
Weight:	75g
Mounting:	4-M2mm

[1] Exclude connectors.

Environmental

Operating Temperature:	4K (-269.15°C)
Non-operating Temperature:	-55~+85°C

How To Order

[FCCC-4000-8000-04-S](#)

Customization is available upon request.

Outline Drawings

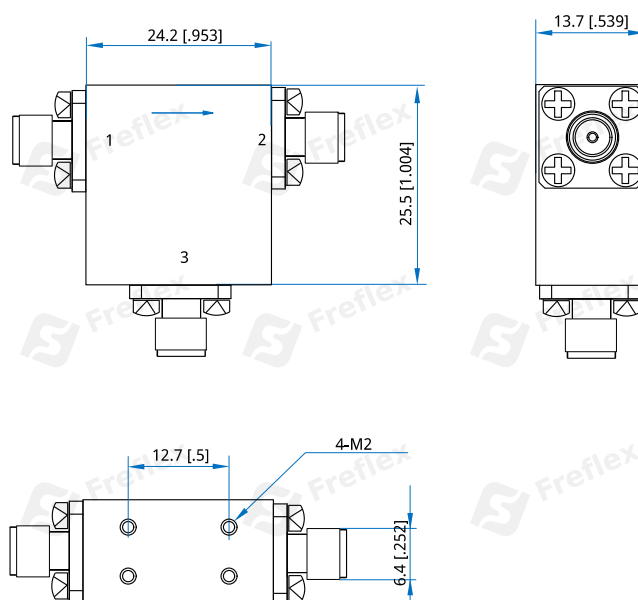

Unit: mm [inch]

Tolerance: .x±1mm [±0.039in]