

## FELC-K-1

### 2.92mm, DC~40GHz

#### Features:

- \* Low VSWR
- \* No welding
- \* Reusable
- \* Easy installation

#### Applications:

- \* Laboratory Test

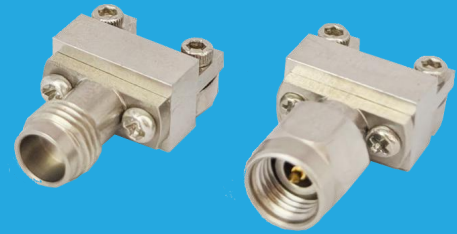

#### Electrical

Frequency:	DC~40GHz
VSWR:	1.25 max.
Impedance:	50Ω

#### Mechanical

RF Connector:	2.92mm
Outer Conductor:	Passivated stainless steel
Dielectric:	PEI & PTFE
Inner Conductor:	Gold plated beryllium copper

#### Environmental

Temperature:	-55~+165°C
--------------	------------

#### Outline Drawings

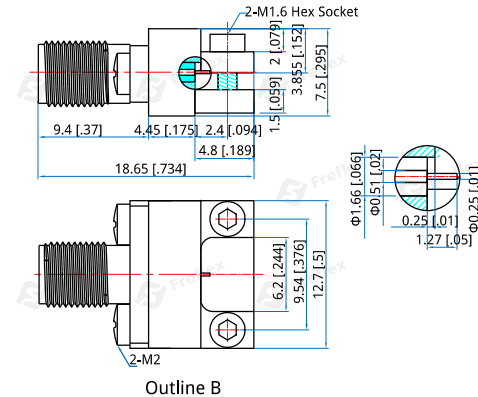
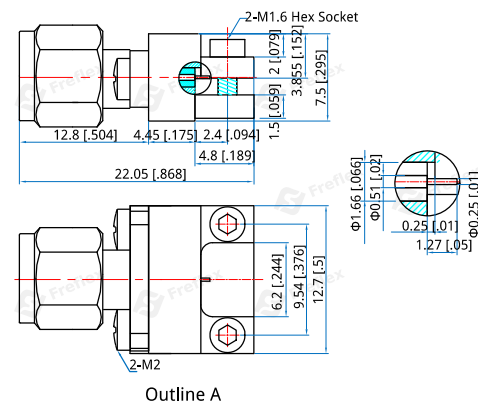

#### PCB Layout

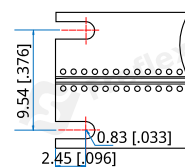

Unit: mm [in]

Tolerance: ±0.2mm [±0.008in]

#### How To Order

**FELC-K-1** - Outline A

**FELC-KF-1** - Outline B

Customization is available upon request.