

FELC-K-3

2.92mm, DC~40GHz

Features:

- * Low VSWR
- * No welding
- * Reusable
- * Easy installation

Applications:

- * Laboratory Test

Electrical

| | |
|------------|-----------|
| Frequency: | DC~40GHz |
| VSWR: | 1.25 max. |
| Impedance: | 50Ω |

Mechanical

| | |
|------------------|------------------------------|
| RF Connector: | 2.92mm |
| Outer Conductor: | Passivated stainless steel |
| Dielectric: | PEI & PTFE |
| Inner Conductor: | Gold plated beryllium copper |

Environmental

| | |
|--------------|------------|
| Temperature: | -55~+165°C |
|--------------|------------|

How To Order

FELC-K-3 - Outline A

FELC-KF-3 - Outline B

Customization is available upon request.

Outline Drawings

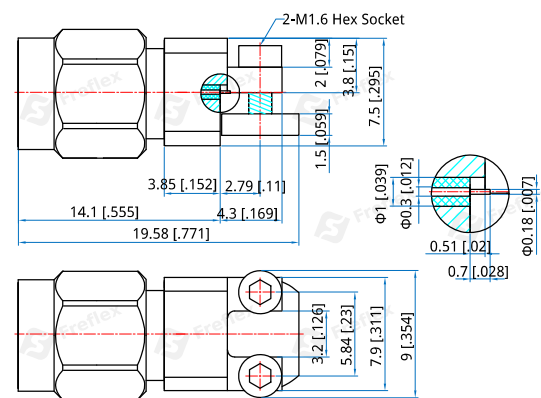

Outline A

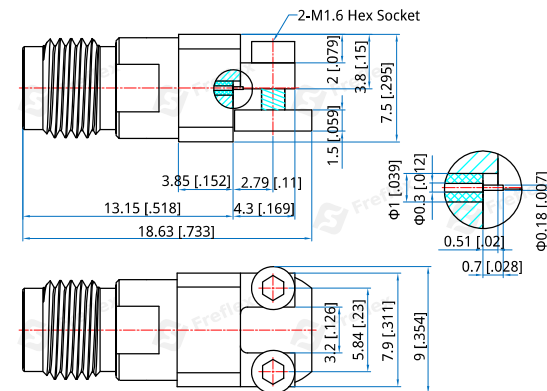

Outline B

PCB Layout

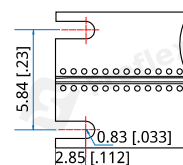

Unit: mm [in]

Tolerance: ±5%

±0.2mm [±0.008in](Screw sleeve)